

Connection Wires

Model : Realtime K2

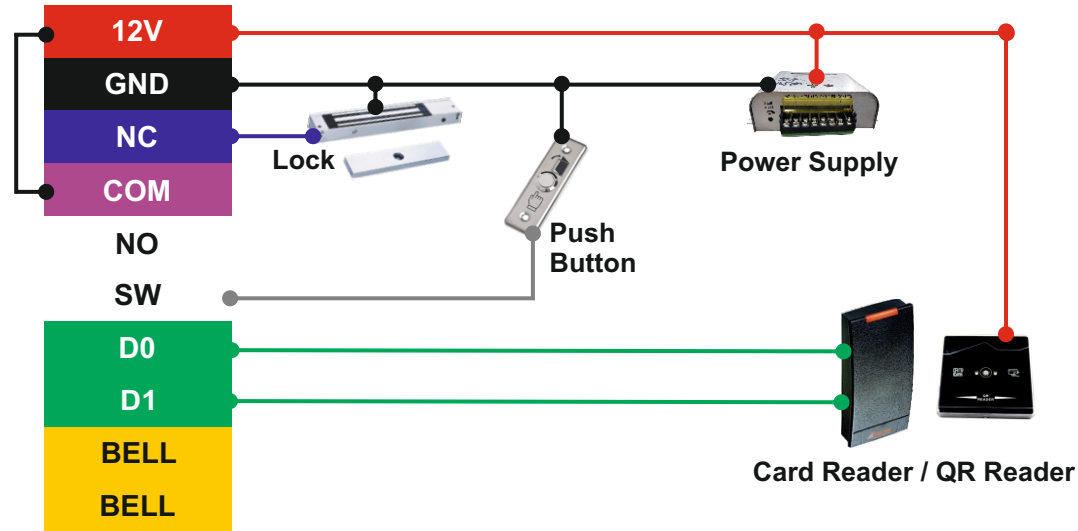

IV. Management card

ADD Management card: Turn off the power and hold down the RESET button then turn the power on, if the red and the blue lights flashing, read a card into normal using status, this card is Management card, you can use it to add or delete user cards.

V. Settings

The original management password is 12345.

Enter programming:

Press *green light flash>input the password># red light always on means the machine has entered the programming. (All the following settings are in programming status)

1. Change management password

Programming state=>0=>password=>#=>repeat =>#=>long press* to quit

2. Add user cards

①. Press 1=>add the blank card (or keep on adding cards) =>press # =>long press * to quit

②. Press 1 =>input 8-digital number of the card =>press # =>long press* to quit

③. Set the machine to automatic add card mod press 3=>03=>#=>press*to quit. users can enter the door with memorizing the cards.

6. Modify password (original 8888)

Press 5=>input new password with 4-digital numbers =>press#=>input again =>press #=>long press * to quit

7. Set to be a carder reader

Press9=>1=>02=>#, then turn off the electric and turn on again. If you want to back to the normal mode, you should initialize the controller. (see PartVI)

8. User data copy (need MC1 module)

① Copy the data from the controller to the module

Press 9=>5=>01=>#

② Import the data from the module to device:

Press 9=>5=>02=>#

During the process green and red light flicker, long buzzer when finished.

VI. Initialization of the door controller

1. Turn off the electricity. hold down the Reset button .

2. Turn on the electricity. hold down the Reset button until a buzzing. Initialization complete.

STATE: After the buzzing ,the machine enter the Using State.

NOTE: Initialization can only change the password to the default password:12345,user password :8888,other data will not be changed.

①.(not in programming status)Read management card =>read the blank card (keep reading)Read the management card twice.

3. Delete user cards

①. Press 2 => input 8-digital number of the card =>press # =>long press * to quit

②. Press 2 =>swiping card (one or more cards) =>press # =>long press * to quit

③. Press 2 =>input 0000 =>press # =>long press * to quit. TO delete all users.

④.(not in programming status)Read the management card twice =>read the cards need to be deleted(keep reading),read the management card again=>finished.

4. Set open model

①. Open with reading a valid card : press 3 => input 00 =>press # =>long press * to quit.

②. Open with reading a valid card plus password : press 3 =>input01 => press # =>long press * to quit.

③. Open with reading a valid card or password: press 3=>input 02 press #=>long press * to quit.

5. Set door open time (initial 3s)

Press 4=>input XX=>press #=>long press* to quit